

THE HEART  
OF THE CITY  
AT YOUR  
DOORSTEP

MID MARKET  
THE CENTER OF IT ALL





# SOMETHING FOR EVERYONE

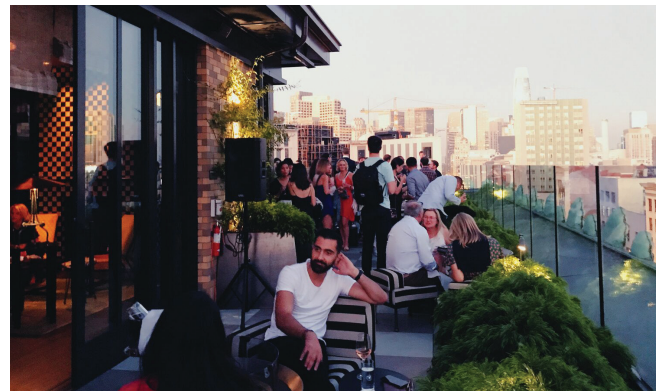

Clockwise from top: IKEA (representational image only), Charmaine's Rooftop Bar & Lounge, and The Warfield

## Meet the NEIGHBORS



Jonathan Carver Moore Gallery (above) and Fermentation Lab (below)

**IKEA NOW OPEN** The much anticipated IKEA is complete with a food hall and on-site indoor parking. The new coworking space will open next year.

**CONVENIENT, EASY ACCESS** Mid Market is bookended by Powell Street and Civic Center BART/MUNI regional transit stations. Autos have access to 19 nearby parking garages. Flat and pedestrian friendly, Mid Market also features vintage streetcars on the F-line, popular with tourists and locals alike.

**MORE PEOPLE ARE LIVING IN MID MARKET** New residential developments such as: Serif, Prism, 50 Jones, Trinity Place, and Nema contributed to a 15% increase in residents living in Mid Market since 2019 and a 42% increase in residents living in the greater Mid Market area, which includes parts of SOMA and Civic Center.









# PERFECTLY POSITIONED

## WHERE DO YOU FIT IN?



Photo credit: Michael Shainblum



SEE WHAT'S AVAILABLE >>> [midmarketcbd.org/retail-space-available](https://midmarketcbd.org/retail-space-available)

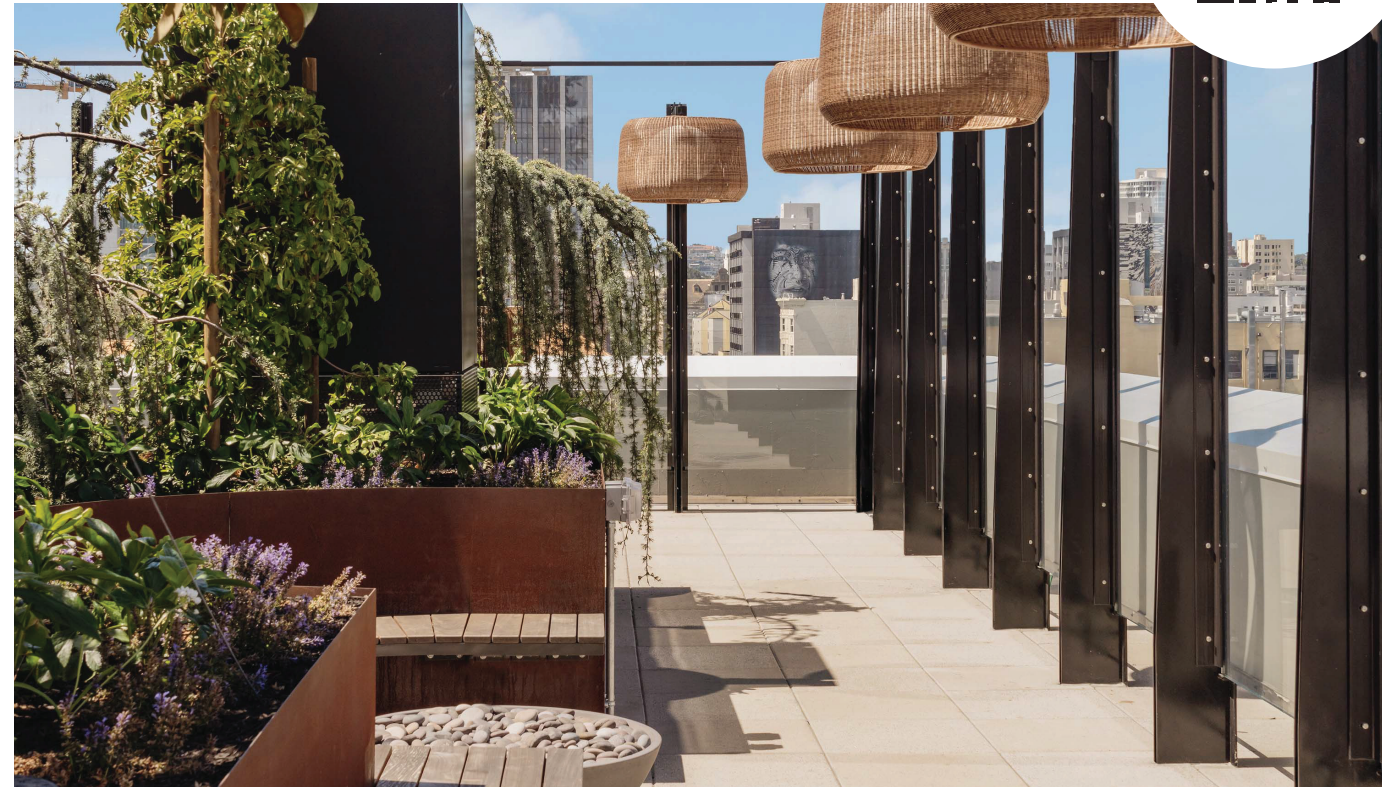

Clockwise: The Market, Orpheum Theatre, and LINE Hotel rooftop (Photo credit: Chase Daniels)